

FENCE
COMMERCIAL or RESIDENTIAL

City of Aurora
Development Services Department
Division of Building and Permits
77 S Broadway
Aurora, IL 60505



APPLICATION #: _____

Total Fees: _____ Submittal Date: _____
Online Portal: <https://auro-trk.aspgov.com/etrakit/> Phone: 630.256.3130 Website: www.aurora-il.org

Property Address: _____ Unit/Suite #: _____
Owner Information (all fields required) Additional Contact Info Applicant Tenant Property Mngr
Name: _____ Name: _____
Address: _____ Address: _____
Phone: _____ Phone: _____
Email: _____ Email: _____

ACKNOWLEDGEMENT OF APPLICATION ONLY

This is an application only. Completion of this application does NOT entitle the commencement of construction. I, (the applicant) agree to conform to all applicable laws of the City of Aurora. I also agree that all work performed will be in accordance with the plans and specifications as set forth in the approved permit. I understand that the approval of this application and issuance of a permit does not preclude the need to comply with all applicable laws and ordinances. I agree to hold harmless and indemnify the City of Aurora for any claim against the City as the result of any act of commission or omission by or on behalf of the undersigned, his/her agent, principle, contractor, subcontractor or supplier. I the undersigned am the Owner or a duly contracted representative of the owner of said property. As part of this application process, I affirm that all the information herein is true and correct to the best of my knowledge. I authorize the City of Aurora to make any reasonable inspections of the property as part of the application and permit process.

Owner Contractor Representative Role: _____

Name: _____ Signature: _____

DESCRIPTION OF WORK

PROPERTY TYPE FOR FENCE INSTALLATION

What property type will this fence installation be on: Commercial Residential

Note that the different types of properties have different requirements based on the Aurora Zoning Ordinance

GENERAL REQUIREMENTS, CONDITIONS and ITEMS for SUBMITTAL

- Submittal requires a copy of current **PLAT OF SURVEY** with indication of fence heights, dimensions, materials, style, and placement
- Fences are not allowed in the Right-of-Way, floodways, drainage swales and easements (without permit review approval)
 - No portion of the fence, including posts or footings, shall extend past the property line
 - Fences adjacent to a public sidewalk must be setback a minimum of one foot (1') from said sidewalk
- The contractor or owner must contact J.U.L.I.E. at 800.892.0123 to mark any and all utilities prior to digging post holes
- Please note approval from your Homeowner's Association may be required and is a separate process from City of Aurora permit process
- Refer to the Aurora Zoning Ordinance [Fence Booklet](#) for more detailed requirements on your fence installation

OPTIONAL INSPECTION

Are you requesting a final inspection of your fence (it is optional for this application type, additional fees will apply): Yes No
If you are requesting an inspection, please provide us with an estimated date of completion to schedule inspection: _____

DISCLAIMER: An inspection of the fence gets assessed the optional additional fee as stated above. Personnel performing fencing inspections do not have the surveying required to verify the fence is in the correct location with respect to your lot lines. By signing the application, you certify that the owner has been informed of the optional city inspection.

Application Fee is due at time of submittal. COST OF WORK: _____

CONTRACTOR AND FENCE INFORMATION

FENCE CONTRACTOR INFORMATION

City of Aurora Registration #: _____
 Business Name: _____
 Contact Name: _____
 Address: _____
 City, State, Zip: _____
 Phone: _____
 Email: _____

Classification of the fence: Open (>50%) Solid (<50%)
 Type of fence material: Wood Metal
 Vinyl PVC
 Other: _____

General fence height: _____

(Variations of fence height should be designated on Plat of Survey and below)

*Property and lot type may restrict fence types and configurations

LOT AND YARD TYPE

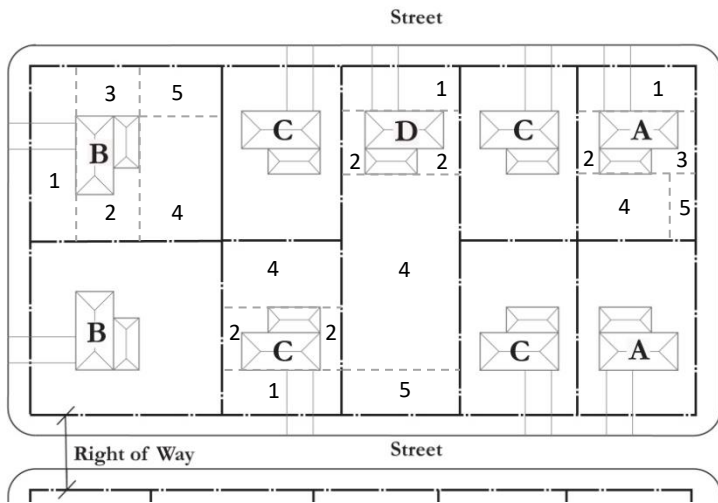

(CHECK ONE)

- Lot Types: A – Corner Lot
 B – Reverse Corner Lot
 C – Interior Lot
 D – Through Lot

(Indicate height for each applicable yard)

- Yard Types: 1 – Front Yard _____ ‘
 2 – Interior Side Yard _____ ‘
 3 – Exterior Side Yard _____ ‘
 4 – Interior Rear Yard _____ ‘
 5 – Exterior Rear Yard _____ ‘

GENERAL FENCING REQUIREMENTS

- The finished side of a fence must face outward with all fence posts located on the inside of the fence owner’s property
- CHAINLINK is strictly prohibited in the front yard as well as along any right-of-way
- Fences shall be constructed of materials customarily used and manufactured as common fence materials
 - Examples of approved materials: ornamental iron, vinyl, masonry, stone, pressure treated lumber, wood with natural resistance to decay
 - Examples of non-approved materials: broken or scrap boards, wire mesh, tarps, fabrics, and any other non-common fence materials
- Fences shall be of uniform height, material, type, color and design for entire length of fence, except for height transitions at one yard to another
- In order to comply with Sight Triangle / Obstructions within 15’ of intersecting property lines at public streets, walks, driveways, bike paths or walking paths, fences shall not exceed three feet (3’) in height, regardless of classification of fence
- If new fence is intended to replace an existing fence in whole or part, all existing fence needs to be removed prior to installation of new fence
- Ornamental post or end caps six inches (6”) or less in height do not count towards the overall fence height, anything larger will.
- Grading at property lines shall not be altered due to fence construction unless a grading plan is submitted and approved by Engineering Division
- The International Property Maintenance Code shall regulate fence maintenance and proper fence construction standards for the entire project
- Fences are not allowed on vacant lots unless the lot is immediately adjacent to a property occupied by a building or buildings under common ownership as the vacant property
- A fence shall not enclose utility boxes
- Fences that completely enclose a residential lot shall have at least one gate access as means of ingress and egress to the principal building
- In townhomes, where a common wall of a structure connects two or more dwelling units, fences for such separate dwelling units shall be of uniform height, material, type, color and design

COMMERCIAL FENCING REQUIREMENTS

- Maximum permitted height is six feet (6’), unless used for screening of bulk materials in which it can be raised to eight feet (8’)
- Chain link and wire mesh is prohibited when a fence is adjacent to a property zoned for residential use.
- Fences are permitted in all yards other than the following:
 - Between the lot line bordering any public right-of-way and the required setback line in O, B1, B2, B3, M1 and M2 zoning districts
- Security fencing, when visible from the public right-of-way, should be ornamental
 - It is unlawful to construct or maintain anywhere within the City a fence equipped with a barbed wire, spikes or any similar device, or any electric charge enough to cause shock. When approved by the Zoning Administrator, barbed wire may be allowed for maximum security in M1, M2, or ORI zoning districts.
- The City may require that fence areas be landscaped with low height plantings or other materials

Initial Submittals: bpcsrgroup@aurora.il.us

Revisions Submittals: bprevisions@aurora.il.us